



35/4 Smith Street LORNE, VIC



3



2



2

## LUXURIOUS FAMILY SPACE IN CENTRAL LORNE

As soon as you enter this modern, expansive, light filled, apartment you are undoubtedly impressed by the sprawling floorplan of 137sqm.

Open plan kitchen, living, dining area opening to enormous, landscaped deck space. Stylish kitchen with Miele appliances, stone bench tops.

3 large bedrooms, master with ensuite (all with BIR) all opening onto rear courtyard capturing the afternoon sun. Enjoy the easy lifestyle living with outdoor swimming pool, secure underground parking (2 parks), large storage cage and lift access to your front door.

Be part of the prestigious and highly sought after Lorne Chalet complex, only a short stroll to main street and beach and desirable rental returns.

**Price:** \$795,000

**Karen Stribling**  
0439 650 838

**Tyrone Provan**  
0405 124 799

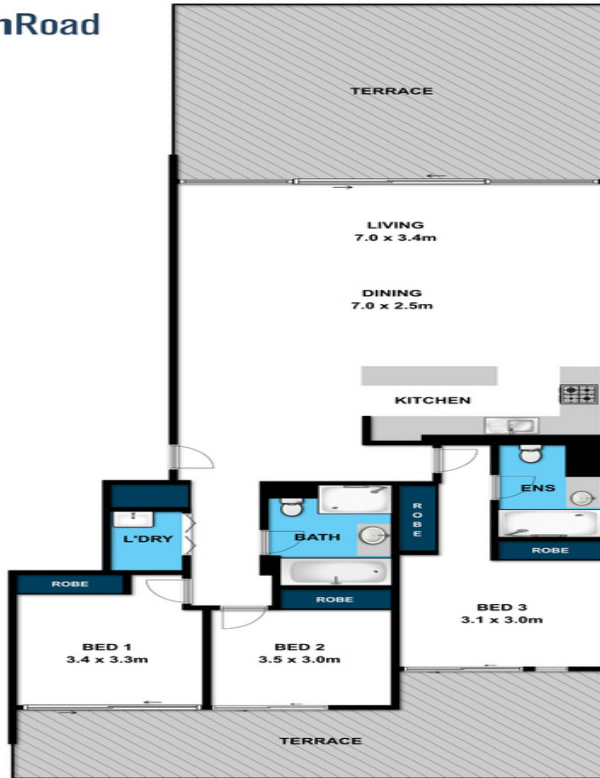

Whilst [bwrm.com.au](http://bwrm.com.au) has made every attempt to ensure the accuracy of the floor plan contained here, measurements are approximate and no responsibility is taken for any error, omission, or mis-statement. This plan is for illustrative purposes only.



**35/4 Smith Street**

**Lorne**