



B311/148-174 Mountjoy Parade LORNE, VIC



Front and Centre family living in Lorne's main str...

Rarely do you get an opportunity to secure a tightly held, front ocean view penthouse apartment located in Lorne's main street and part of the iconic and ever popular Cumberland Lorne.

Price: \$865,000

Sitting proudly within the Berengaria block, lift access from carpark level to your front door, the apartment is set over 2 generous levels. Lower level incorporates an open plan kitchen, living, dining area opening to front deck capturing a spectacular view down Lorne's main street and onto the rolling waves hitting the front beach. This level also boasts main bathroom/laundry and second bedroom. The upper level is all about relaxation and coastal living with master bedroom, ensuite with corner spa all opening to enormous timber deck space, large enough to entertain the family and friends while enjoying truly one of the best views you will find in town!

Karen Stribling
0439 650 838

Tyrone Provan
0405 124 799

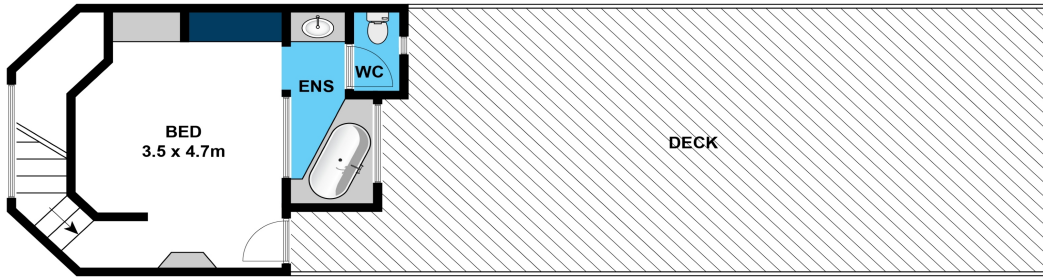

UPPER LEVEL

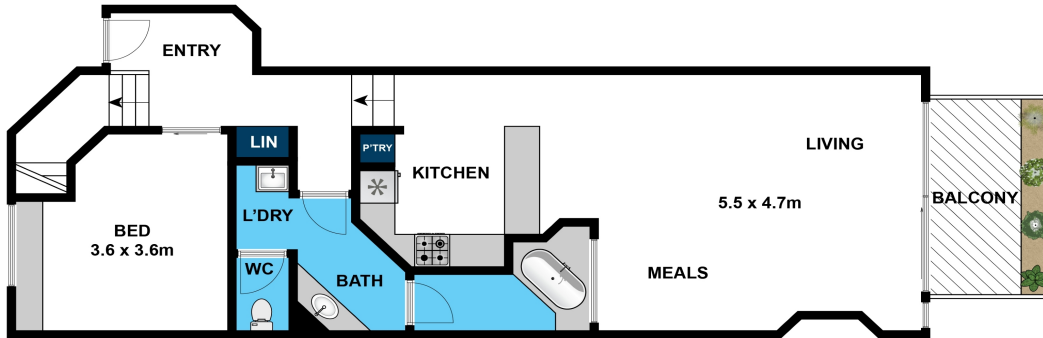

LOWER LEVEL

Approx. Area 100m²

Whilst bwr.com.au has made every attempt to ensure the accuracy of the floor plan contained here, measurements are approximate and no responsibility is taken for any error, omission, or mis-statement. This plan is for illustrative purposes only.



B311 Cumberland Resort

Lorne