



34A Berthon Street AIREYS INLET, VIC



BEACHSIDE BOLTHOLE

Conveniently positioned in a quiet cul de sac on a natural 800sqm flat allotment hidden away on the beach side of the Great Ocean Road.

Price: \$895,000

In a delightful bush setting, the compactness of this architect designed beachside getaway provides intimacy and warmth.

The high ceilings and numerous windows provide natural light and allow for the warmth of the winter sun to permeate through the house.

Rich timber floors and white walls perfectly reflect its bush setting whilst the expansive deck area has its own outdoor fireplace perfect for outdoor living after dark.

Situated an easy walk from beaches, shops, cafes and the iconic Aireys Pub. This unique package is sure to impress and delight

James Worssam
0418 585 815

Ben Jackson
0437 380 706

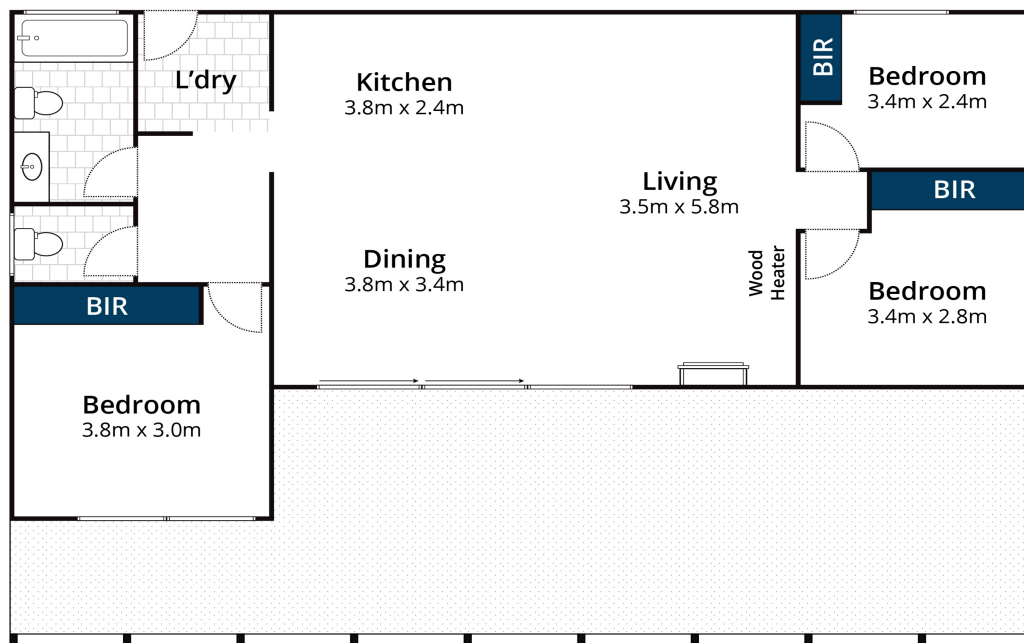

Approx. Area 95m²

Whilst bwrn.com.au has made every attempt to ensure the accuracy of the floor plan contained here, measurements are approximate and no responsibility is taken for any error, omission, or mis-statement. This plan is for illustrative purposes only.



34A Berthon Street, Aireys Inlet