

25 Toorak Terrace LORNE, VIC



4



2



6

## THE PERFECT MATCH ? LARGE LUXURY HOME IN PRIME POS...

Located in an exclusive and highly desired precinct of Lorne, just a short drive or 10 minute walk to the beach, is this meticulously presented and maintained residence, built by top coastal builder GD Constructions.

The property oozes sophistication, privacy and class. Direct street entry to the open plan living level boasts a well- proportioned, sleek kitchen featuring stone bench tops, island bench and European stainless-steel appliances. The dining zone also continues relaxed living, framed by a corner feature open fire place.

Floor to ceiling wrap-around windows expand the front of the property, opening to the outdoor entertainer's deck, taking in the surrounds of Loutitt Bay and Aireys Inlet Lighthouse blended through the natural Eucalypts, so special to Lorne.

**Price:** \$1,395,000

**Karen Stribling**  
0439 650 838

**Ian Stewart**  
0418 522 571

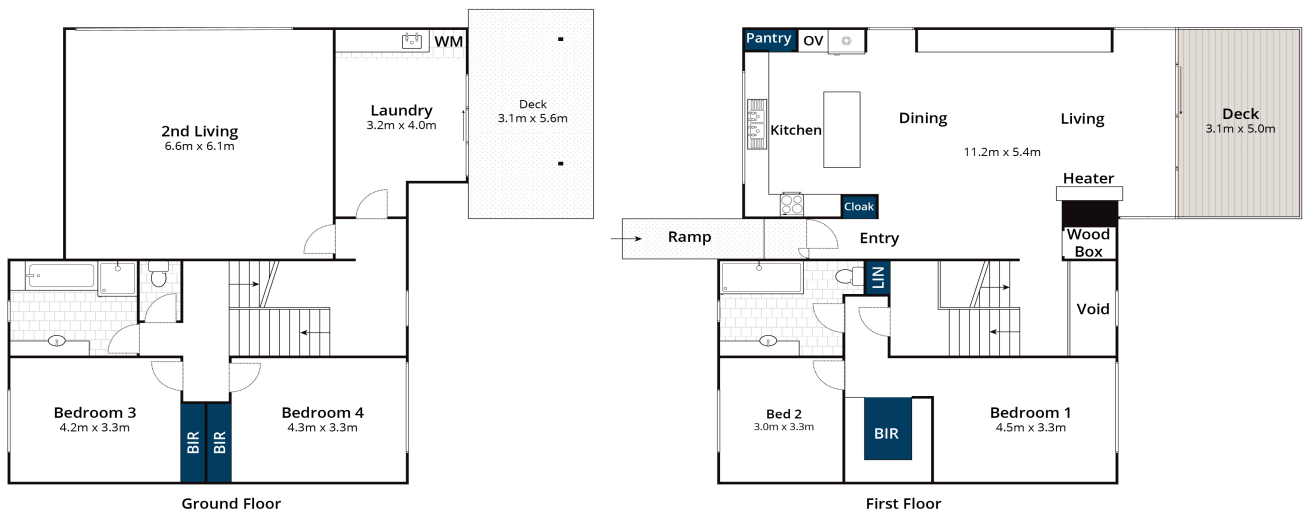

Whilst [bvr.com.au](http://bvr.com.au) has made every attempt to ensure the accuracy of the floor plan contained here, measurements are approximate and no responsibility is taken for any error, omission, or mis-statement. This plan is for illustrative purposes only.



## 25 Toorak Terrace, Lorne