



10/3-9 Armytage Street Lorne, VIC



3



2



2

## MODERN, SPACIOUS, BEACH SIDE LIVING

Located in the south end of the boutique apartment complex, Point Grey. Modern and family sized, double storey beach villa. The Upper level boasts a generous, light filled and modern open plan kitchen, living/dining space opening to outdoor deck, capturing a fabulous north, east ocean and coast vista.

With its own private separate entrance, the lower level is well designed with 3 large bedrooms, 2 bathrooms (master with ensuite) and a second living space perfect as a 4th bedroom or teenager's retreat. This multi living space opens to a large, private outdoor entertaining area, also taking in a peaceful north facing ocean view.

With lift access from the secure underground car park straight to each of the two generous villa levels, large lock up storage and only a short, easy stroll to Lorne's main street or Point Grey precinct.

**Price:** \$1,400,000

**Karen Stribling**  
0439 650 838

**Tyrone Provan**  
0405 124 799

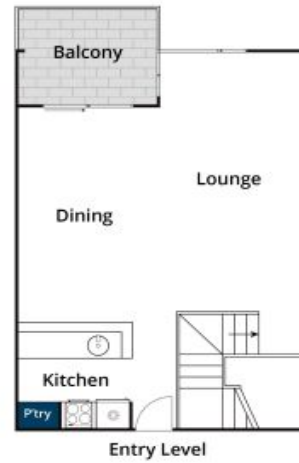
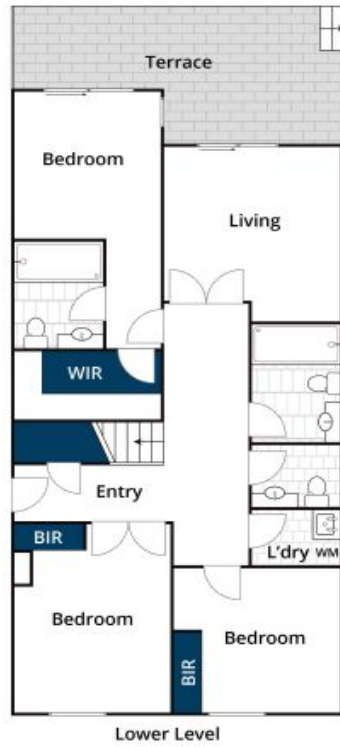

Whilst [www.bwrm.com.au](http://www.bwrm.com.au) has made every attempt to ensure the accuracy of the floor plan contained here, measurements are approximate and no responsibility is taken for any error, omission, or mis-statement. This plan is for illustrative purposes only.



## 10/3-9 Armytage Street, Lorne