



10/3-9 Armytage Street Lorne, VIC



3



2



2

MODERN, SPACIOUS, BEACH SIDE LIVING

Located in the south end of the boutique apartment complex, Point Grey. Modern and family sized, double storey beach villa. The Upper level boasts a generous, light filled and modern open plan kitchen, living/dining space opening to outdoor deck, capturing a fabulous north, east ocean and coast vista.

With its own private separate entrance, the lower level is well designed with 3 large bedrooms, 2 bathrooms (master with ensuite) and a second living space perfect as a 4th bedroom or teenager's retreat. This multi living space opens to a large, private outdoor entertaining area, also taking in a peaceful north facing ocean view.

With lift access from the secure underground car park straight to each of the two generous villa levels, large lock up storage and only a short, easy stroll to Lorne's main street or Point Grey precinct.

Price: \$1,400,000

Karen Stribling
0439 650 838

Tyrone Provan
0405 124 799

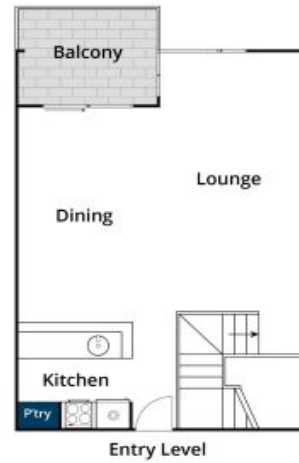
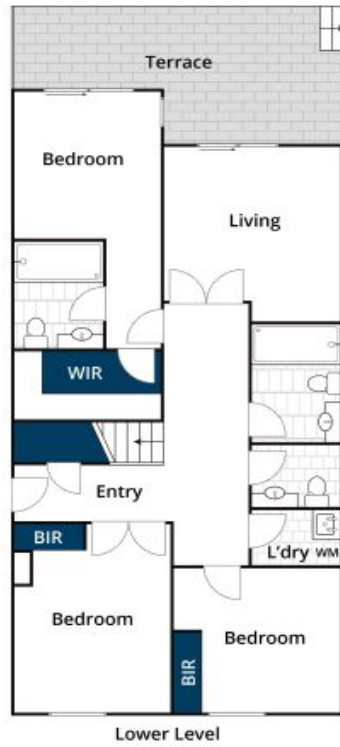

Whilst bwrn.com.au has made every attempt to ensure the accuracy of the floor plan contained here, measurements are approximate and no responsibility is taken for any error, omission, or mis-statement. This plan is for illustrative purposes only.



10/3-9 Armytage Street, Lorne