



388 Red Johanna Road Johanna, VIC



3



1



4

WHERE EAGLES DARE

Perched above the Johanna Beach, surrounded by rolling hills and a bird's eye view over the ocean & Johanna surf beach.

Situated at the end of the Red Johanna Road, offering the most tranquil location but only a 10 minute walk to the main surf beach.

This 3 bedroom brick veneer home, set on 1 acre is immaculately presented for its era. Maximizing its fabulous position the single level home and living spaces capture the breathtaking views. Also offering ample outbuildings including a large 30x50x10ft high shed.

Why be down with the Turkeys surrounded by people, cars & noise, when you can soar like an eagle with just the sound of the ocean!

Price:

Under Offer

Darren Brimacombe

0418 317 424

Kirsten Body

0457 899 941

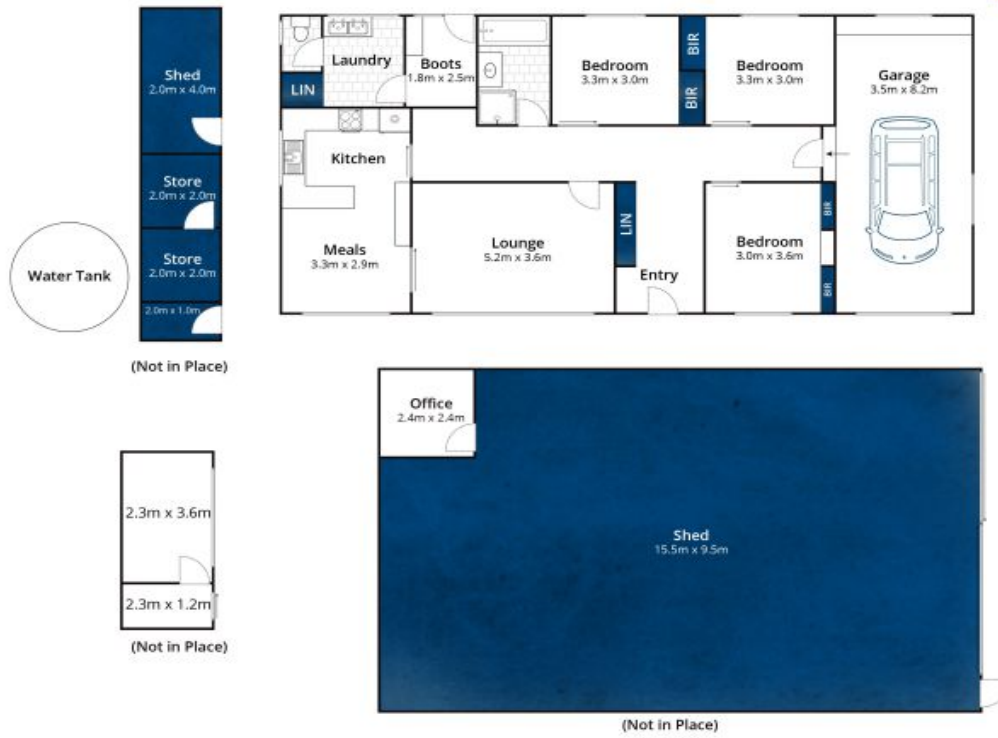

Approx. Area 149m²

Whilst bwrn.com.au has made every attempt to ensure the accuracy of the floor plan contained here, measurements are approximate and no responsibility is taken for any error, omission, or mis-statement. This plan is for illustrative purposes only.

388 Red Johanna Road, Johanna