



10 Skyline Court Lorne, VIC

 4  3  2

## SERENITY AND SPACE ON SKYLINE

Luxuriously appointed, architecturally designed, 4 bedroom family beach residence exemplifying quality craftsmanship whilst set amongst a privately secluded natural environment with state reserve at the back door.

Impressive open plan living, dining, kitchen with Euro appliances and chefs larder. The lounge area has a roaring open fire and opens onto 2 expansive decks, facing north and south allowing you to follow the sun all day.

Rumpus and store rooms downstairs plus double garage and laundry make this a feature packed house accommodating the largest of families.

Featuring soaring high ceilings, polished concrete and hardwood floors, under slab heating

**Karen Stribling**

0439 650 838

**Michael Coutts**

0438 356 624

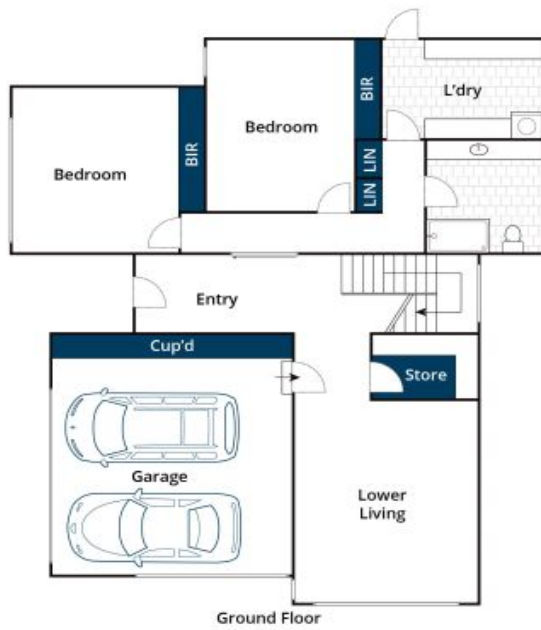

Whilst [bwrn.com.au](http://bwrn.com.au) has made every attempt to ensure the accuracy of the floor plan contained here, measurements are approximate and no responsibility is taken for any error, omission, or mis-statement. This plan is for illustrative purposes only.



## 10 Skyline Court, Lorne