



66 Murray Street Anglesea, VIC



3



2



4

## 'COOP'S PLACE'

'Coop's Place' has a great rustic feel that invites relaxed living for casual beach days. The house layout is designed around the brilliant eclectic garden that has captured the true essence of the Australian landscape. Special creative places throughout feature the excellent land size of approx. 741 sqm welcoming outdoor entertaining for embracing the environment. This single level house offers 3 bedrooms, master with ensuite and its own little deck through a sliding door plus a second living room creating an independent zone at the rear of the house. The front has open living with wood fire & split system and easy access to the galley style kitchen, bathroom and two bedrooms. There is a large lock up garage / storage shed, separate laundry & powder room plus timber floors. Wonderful Anglesea location, with the ability to walk to the end of Murray Street to Main Beach & the Surf Club. The river, Coogoorah Park & walking tracks are also just around the corner plus convenient amenities including golf club, shops, cafes, restaurants. A position like this is highly sought after and offers a positive investment opportunity for the future.

**Price:**

\$705,000

**Nicole Spiteri**

**Ben Jackson**

0437 380 706

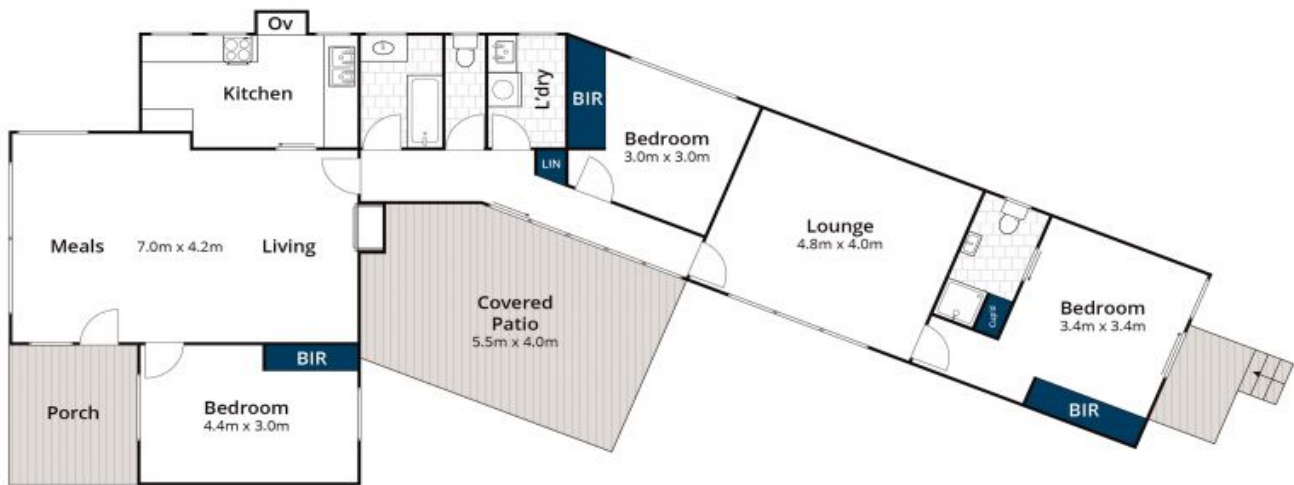

Whilst [brwm.com.au](http://brwm.com.au) has made every attempt to ensure the accuracy of the floor plan contained here, measurements are approximate and no responsibility is taken for any error, omission, or mis-statement. This plan is for illustrative purposes only.

## 66 Murray Street, Anglesea