



16 Campbell Court Apollo Bay, VIC



3



2



4

## SANDSTONE HOME ON 1200M2

This superbly built home, situated in a quiet cul-de sac will provide the astute investor an opportunity to further develop (S.T.C.A).

Standing on the large deck at the rear of the property there are beautiful views across the bay towards the Apollo Bay Harbour.

The two levels of the property provide a comfortable, easy living floorplan; on the top level an open plan kitchen/dining and family space, opening to a lovely spacious deck, perfect for family entertaining or just sitting back to relax and enjoy the view.

The master bedroom on the upper level is complimented by an ensuite and walk in robe. The lower level offers a further two bedrooms with built in robes, a family bathroom with separate bath, and laundry. A double, remote controlled lock up garage completes this home.

**Price:**

**\$880,000**

**Darren Brimacombe**

0418 317 424

# 16 Campbell Court, Apollo Bay

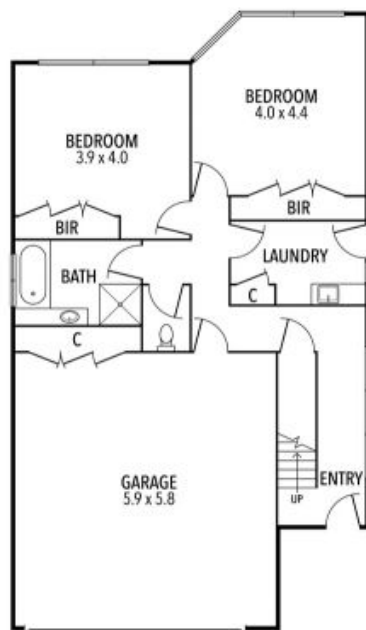

GROUND FLOOR



FIRST FLOOR



THE ABOVE PLAN IS AN ARTIST'S IMPRESSION ONLY, IT INCLUDES ELEMENTS THAT ARE FOR DISPLAY PURPOSES ONLY AND MAY NOT BE TO SCALE.  
LANDSCAPING SHOWN IS INDICATIVE ONLY. DIMENSIONS ARE APPROXIMATE.

