



1205 Winchelsea-Deans Marsh Road Winchelsea South, VIC

 13  6  20

THRIVING DOG FRIENDLY HOLIDAY COTTAGE BUSINESS - A...

Welcome to one of the Otway's most desirable treechange opportunities!! Work, live and breathe the absolute epitome of the Otway rural lifestyle here at the award winning 4-star, Countrywide Cottages!

Beautifully set over 26 acres of pristine farm and bushland, as you enter the front gates you will be drawn to the well-established and thought-out plantings to compliment the residence's privacy and optimal liveability! Overlooking the centrepiece dam, is the 'residence'. Immaculately presented, comprising of an enviable timber kitchen offering plenty of room for entertaining, open plan living, dining and reading nook, warmed by an abundance of natural light and wood fire heater. 3 bedrooms, 2 bathrooms, master with ensuite, all opening to an undercover deck and taking in views of the picturesque dam, rolling hills and stunningly bound by fabulous vegetable gardens, woodfire pizza oven, west facing, wisteria drenched pergola for afternoon drinks plus well established shedding/storage areas.

Price: \$3,000,000

Karen Stribling

0439 650 838

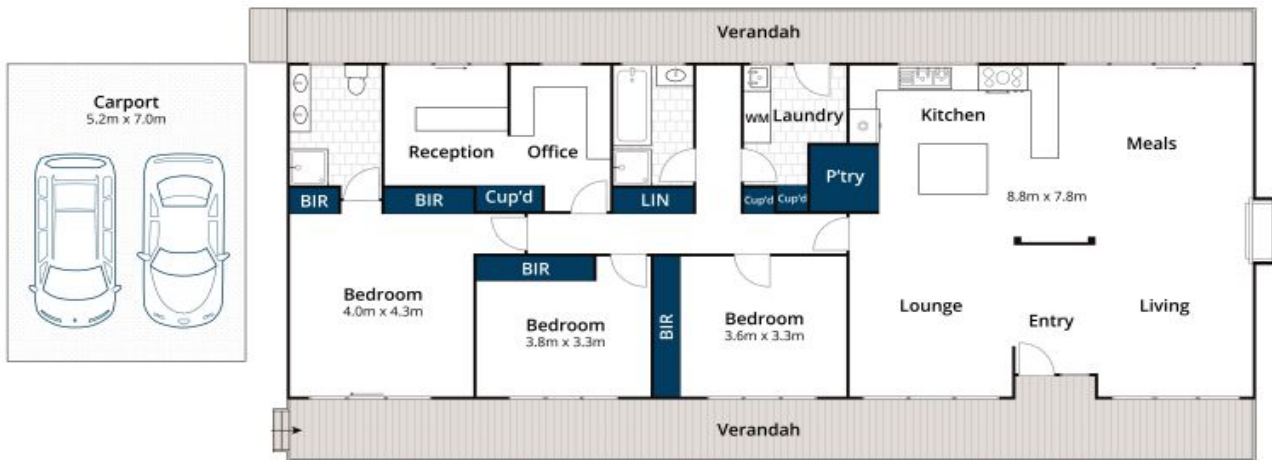

Approx House Area 162m²

Whilst brwm.com.au has made every attempt to ensure the accuracy of the floor plan contained here, measurements are approximate and no responsibility is taken for any error, omission, or mis-statement. This plan is for illustrative purposes only.

1205 Winchelsea-Deans Marsh Road, Winchelsea South