



25 Beach Road Aireys Inlet, VIC

 4  2  2

## CENTRAL, HIDDEN GEM WITH OCEAN VIEWS

Hidden from street view and nestled away at the end of a long driveway, sits this impressive Madge Alexandra designed coastal statement.

On a large block of over 2500m<sup>2</sup> and with ocean views across to Lorne, its size and central position close to town makes this a rare offering. With lots of land surrounding the house, your privacy is assured.

The striking residence comprises four well sized bedrooms with the main bedroom (with walk through robe and full ensuite) separate from the other three bedrooms. The main bedroom is vast and even provides ocean views from the bed!

The open kitchen and dining area is highlighted by hardwood timber floors and a thatched ceiling, with a variety of spaces to find your own privacy if required and is separated from the lounge area by an impressive central wood heater which also services the hydronic heating throughout the house. The sunken lounge area has gorgeous ocean views through to Lorne and beyond over the grassed area.

**James Worssam**

0418 585 815

**Ben Jackson**

0437 380 706

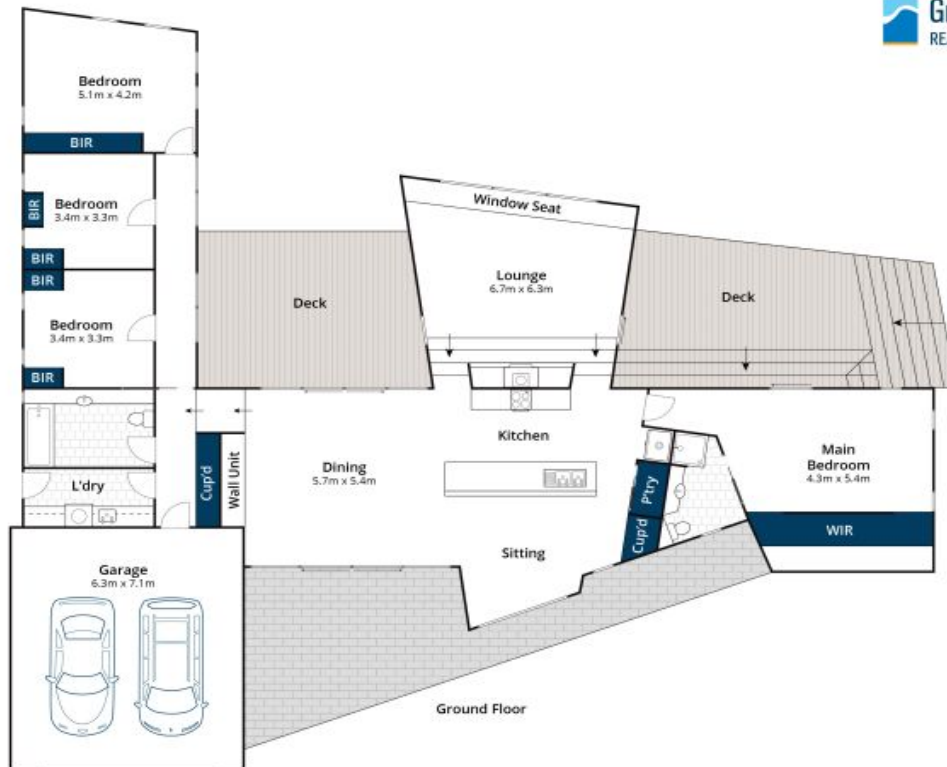

Whilst [bwrn.com.au](http://bwrn.com.au) has made every attempt to ensure the accuracy of the floor plan contained here, measurements are approximate and no responsibility is taken for any error, omission, or mis-statement. This plan is for illustrative purposes only.

## 25 Beach Road, Aireys Inlet