



651A Great Ocean Road Eastern View, VIC

 2  2  2

180 DEGREE OCEAN VIEWS OPPOSITE THE BEACH

A truly unique property offering 180° ocean views which can never be compromised.

Perched above the Great Ocean Road and in front of the expansive Eastern View beach and built in the mid 1980's this solid, concrete townhouse is unique to the area.

Designed for low maintenance beachside living and orientated to take full advantage of the beach views while taking in the northern sun and rear hills outlook. It is also designed to be energy efficient and very quiet. One of two units with a party wall and common property as tenants in common. Providing level entry access from the rear, the townhouse is set over multiple levels and comprises two bedrooms, two bathrooms, open plan kitchen/living and a downstairs dining area.

James Worssam

0418 585 815

Liz Currie

0437 213 229

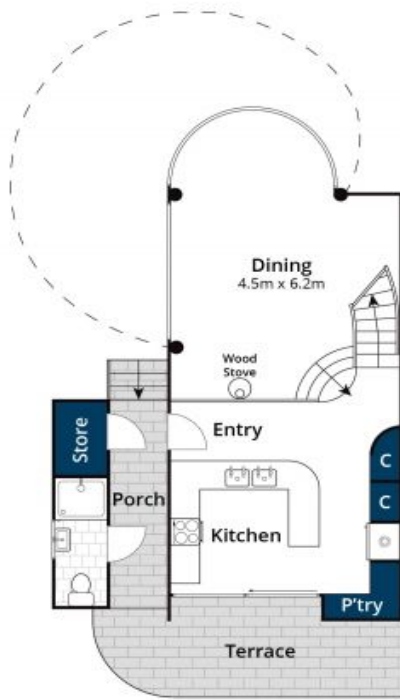

Ground Floor

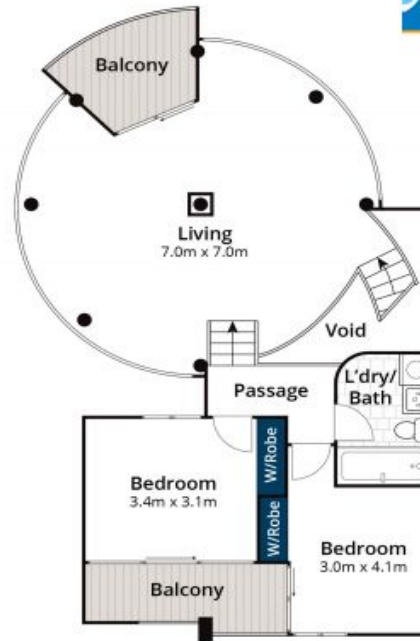

First Floor

Approx House Area 128m²

Whilst bwrn.com.au has made every attempt to ensure the accuracy of the floor plan contained here, measurements are approximate and no responsibility is taken for any error, omission, or mis-statement. This plan is for illustrative purposes only.

651A Great Ocean Road, Eastern View