

40 Deans Marsh-Lorne Road Deans Marsh, VIC



1



1

REJOICE IN YOUR RURAL SLICE OF HEAVEN!

A truly unique and exciting opportunity to preserve, expand and be part of Deans Marsh's long history! Circa 1884, St Paul's Anglican Church and Parish Hall are being offered for private sale. Sited on approx. 2582sqm within the Township zone, the site also to comply with Surfcoast Shire Heritage overlay.

Overlooking Frog Wood Arboretum and located in the heart of the much-loved Deans Marsh township, the charming original interior of the church boasts traditional cathedral ceiling, leadlight window and raw mixture of timbers.

Take advantage of this well orientated flat allotment house site, work with the existing church and hall structures and add to it your dream idyllic retreat (S.T.C.A.).

Price:

\$630,000

Karen Stribling

0439 650 838

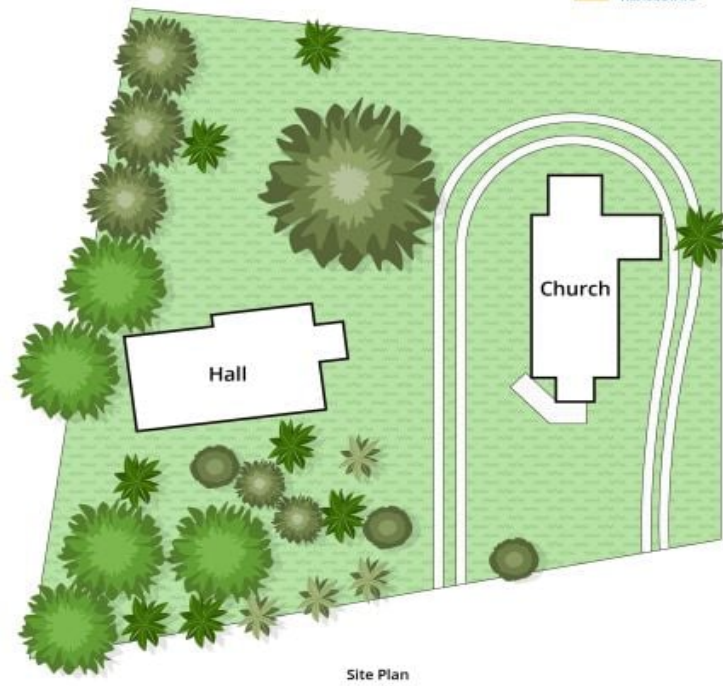
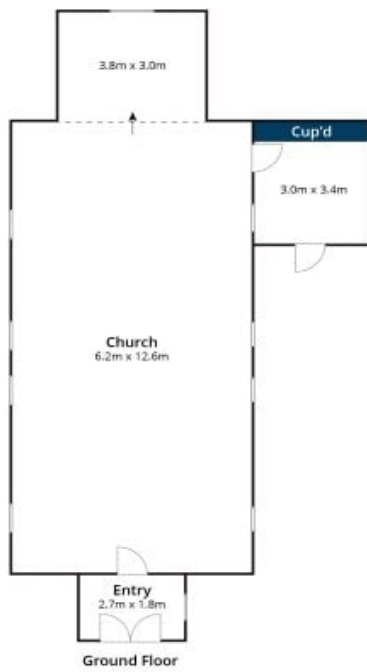

Approx House Area 107m²
Approx Land Area 2595m²

Whilst bwrn.com.au has made every attempt to ensure the accuracy of the floor plan contained here, measurements are approximate and no responsibility is taken for any error, omission, or mis-statement. This plan is for illustrative purposes only.



40 Lorne Deans Marsh Road, Deans Marsh