



122 Harvey Street Anglesea, VIC

 3
  2
  2

## SENSATIONAL SURROUNDS

Backing onto the Anglesea Heath National Park and capturing beautiful leafy views, this private 3-bedroom home is set on an expansive 1000 sqm (approx). The garden is a sanctuary for those who appreciate the beauty of an untouched natural world. A blank canvas of endless possibilities to create your own oasis.

Open the rear garden gate and enjoy direct access to the Anglesea Heath, walking and bike trails where you can connect with nature, find peace and be reminded of the simple, timeless beauty of the outdoors.

This double storey home exudes charm with its welcoming appeal, lofty ceilings and light filled spaces with your choice of sheltered front or rear outdoor entertaining areas. This makes the ideal beach house. The verandah is perfect for your morning coffee or afternoon drinks with friends. Imagine sinking into your chair and watching wrens and kookaburras drinking from the bird baths whilst you unwind from your worldly concerns.

**Inspect:** Saturday, 25th May 2024 1:00 - 1:30

**Price:** \$1,350,000

**Paula Fowler**  
0407 031 178

**Karen Stribling**  
0439 650 838



Ground Floor

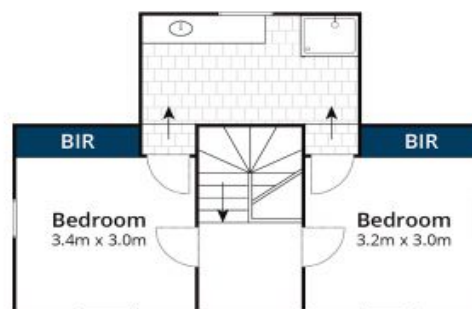

First Floor

Approx House Area 142m<sup>2</sup>

Whilst [brm.com.au](http://brm.com.au) has made every attempt to ensure the accuracy of the floor plan contained here, measurements are approximate and no responsibility is taken for any error, omission, or mis-statement. This plan is for illustrative purposes only.

**122 Harvey Street, Anglesea**