



12 Cassidy Drive Kennett River, VIC

 2  2  1

## CASUAL COASTAL LIVING

Locally designed and built to perfectly occupy the 570 sqm allotment maximising privacy, sun and the amazing ocean views to the east.

Otway National Park is directly opposite creating a magical pristine outlook full of Kennett River local wildlife (koalas, wallabies, birdlife etc). Expansive decking and huge commercial grade sliding doors create the ultimate indoor/outdoor living experience and viewing platform.

This 2 year old home is robustly constructed externally, however the "Wormy Chestnut" timber flooring, soft ply panels and timber cabinetry beautifully softens the home internally. It's what you should expect from a beach home!

Comprising two bedrooms, two bathrooms, European laundry and expansive kitchen/dining/living on the upper level.

**Price:** \$1,575,000

**Michael Coutts**

0438 356 624

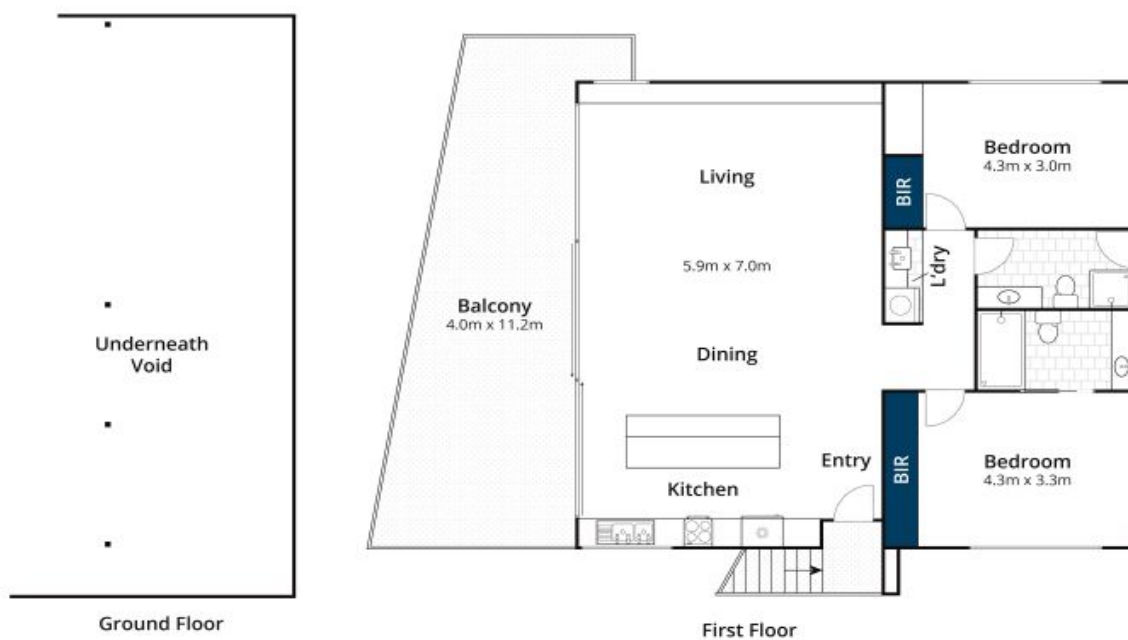

Whilst [bwrm.com.au](http://bwrm.com.au) has made every attempt to ensure the accuracy of the floor plan contained here, measurements are approximate and no responsibility is taken for any error, omission, or mis-statement. This plan is for illustrative purposes only.

## 12 Cassidy Drive, Kennett River