



3 Roache Court Lorne, VIC

 4

 3

 3

FAMILY ORIENTATED BEACH HOUSE

Situated high atop North Lorne with a stunning ocean aspect, which can be enjoyed from both levels. This generously proportioned "Edgard Pirrota" designed home delivers the ultimate coastal lifestyle comprising four large bedrooms, three bathrooms and multiple living areas indoor and out.

The open plan kitchen/dining/lounge area opens onto the expansive deck, the ideal setting for outdoor entertaining with a stunning backdrop. Double car garage with loads of internal storage with direct access into the home and stunning spotted gum flooring contributes to the fresh beachy vibe of this low maintenance property, offering the ease and practicality of a set and forget holiday or permanent home.

Price: \$2,075,000

Tyrone Provan
0405 124 799

Michael Coutts
0438 356 624

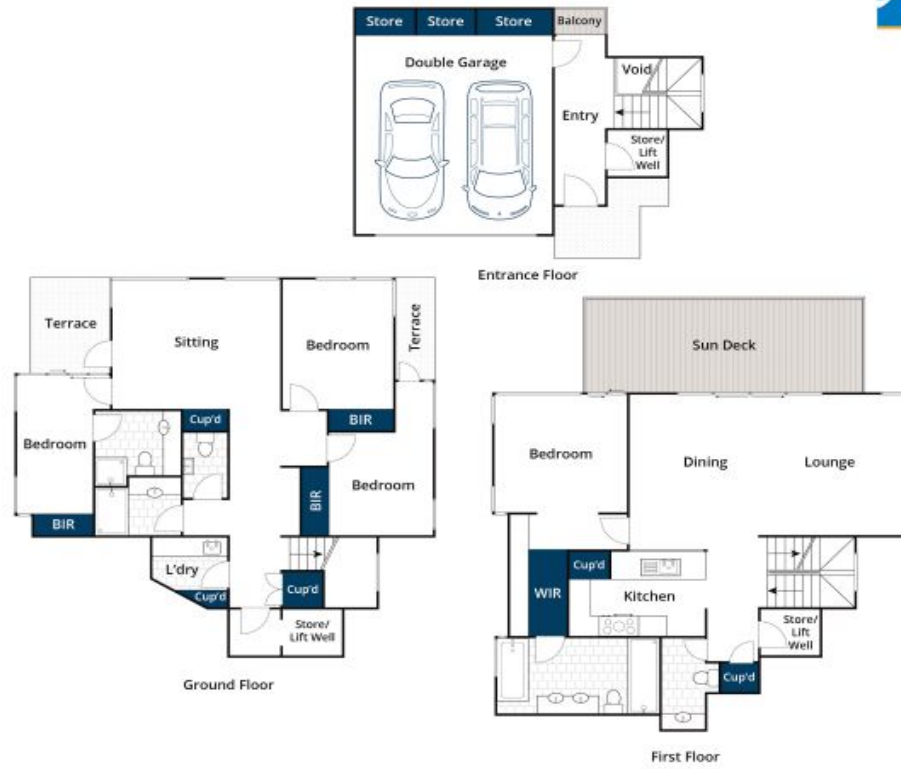

Whilst bwrn.com.au has made every attempt to ensure the accuracy of the floor plan contained here, measurements are approximate and no responsibility is taken for any error, omission, or mis-statement. This plan is for illustrative purposes only.



3 Roache Court, Lorne