



30 Melba Parade Anglesea, VIC



5



3



6

OCEAN PANORAMA PRESTIGE ON MELBA

Perched in a prestigious front-row position, 30 Melba Parade is a triumph of coastal architecture, offering 210-degree ocean views that stretch from Point Addis to Lorne. This tri-level, curved design home by a renowned local builder captures the essence of Point Roadknight living—serene, luxurious, and utterly captivating. Every element of this residence is crafted to enhance the stunning oceanic backdrop and lush greenery that defines the region, ensuring that the breathtaking seascapes become a daily luxury.

One owner has immaculately kept this prized address, now available fully furnished with a globally curated collection of solid teak and rattan pieces. Each of the five bedrooms, three bathrooms, and four living areas across every level is a testament to the home's earthy, elegant aesthetic, featuring sandstone floors and a feature fireplace.

Paula Fowler

0407 031 178

Karen Stribling

0439 650 838

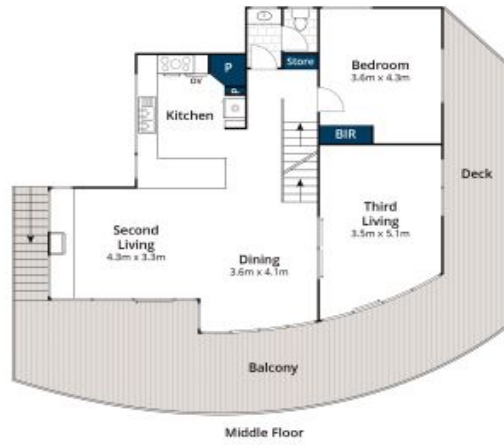

Whilst bwrm.com.au has made every attempt to ensure the accuracy of the floor plan contained here, measurements are approximate and no responsibility is taken for any error, omission, or mis-statement. This plan is for illustrative purposes only.

30 Melba Parade, Anglesea