



9 Alastair Court Apollo Bay, VIC

 4  2  3

PARED-BACK COASTAL ELEGANCE

Just minutes to the beach, this lovely family home is situated in an established cul-de-sac in a very highly sought-after location. The property enjoys an elevated position with exceptional views and is surrounded by other quality homes. Crisp white weatherboards and hardwood timber features epitomize the modern coastal aesthetic and provide abundant street appeal.

The interior does not disappoint either. The home has been finished throughout in a soft light palette combined with blonde timber flooring, resulting in a tranquil and elegant ambience. Large windows throughout let in plenty of natural light and the well-planned layout delivers enough room for the largest of families.

Price: \$1,250,000 to \$1,290,000

Darren Brimacombe
0418 317 424

Kirsten Body
0457 899 941

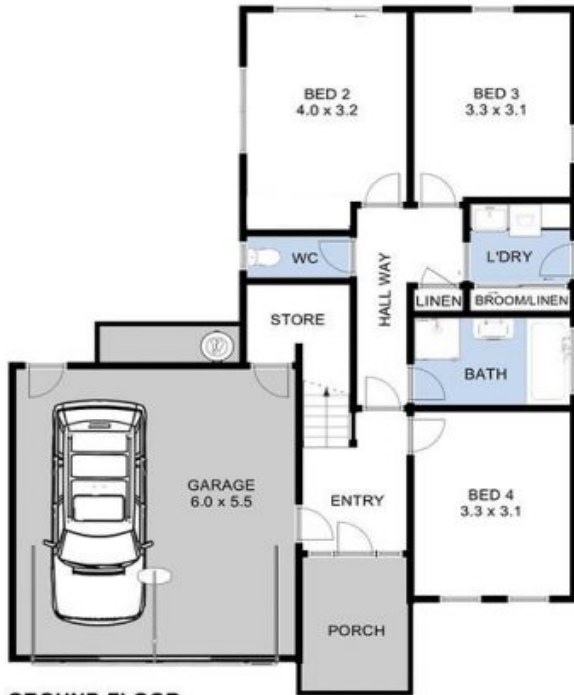

DISCLAIMER: PLEASE NOTE PLANS ARE INDICATIVE ONLY AND NOT DRAWN TO EXACT SCALE. ALL DIMENSIONS ARE APPROXIMATE. POTENTIAL BUYERS SHOULD VIEW THE PROPERTY IN PERSON.