



7 Bambra Road Aireys Inlet, VIC



3



2



2

CHARACTER AND CHARM ON A FLAT ALLOTMENT OF 1222M2

Properties on large, flat allotments in the central part of Aireys Inlet are becoming ever more scarce. Especially so when the blocks are as large as 1222m2 and are totally flat, providing multiple uses.

The land size qualifies for a two lot subdivision (STSA) under the shire's guidelines however the placement of the house may require some modification to the dwelling to bring it to fruition. The bulk of the land is at the rear providing a vast backyard ideal for children to play or due to the rich soil in this part of Aireys Inlet so close to the river, it could provide a fantastic opportunity for the gardener.

Inspect:

Saturday, 11th May 2024 1:00 - 1:30

Price:

\$1,350,000 - \$1,500,000

James Worssam

0418 585 815

Liz Currie

0437 213 229

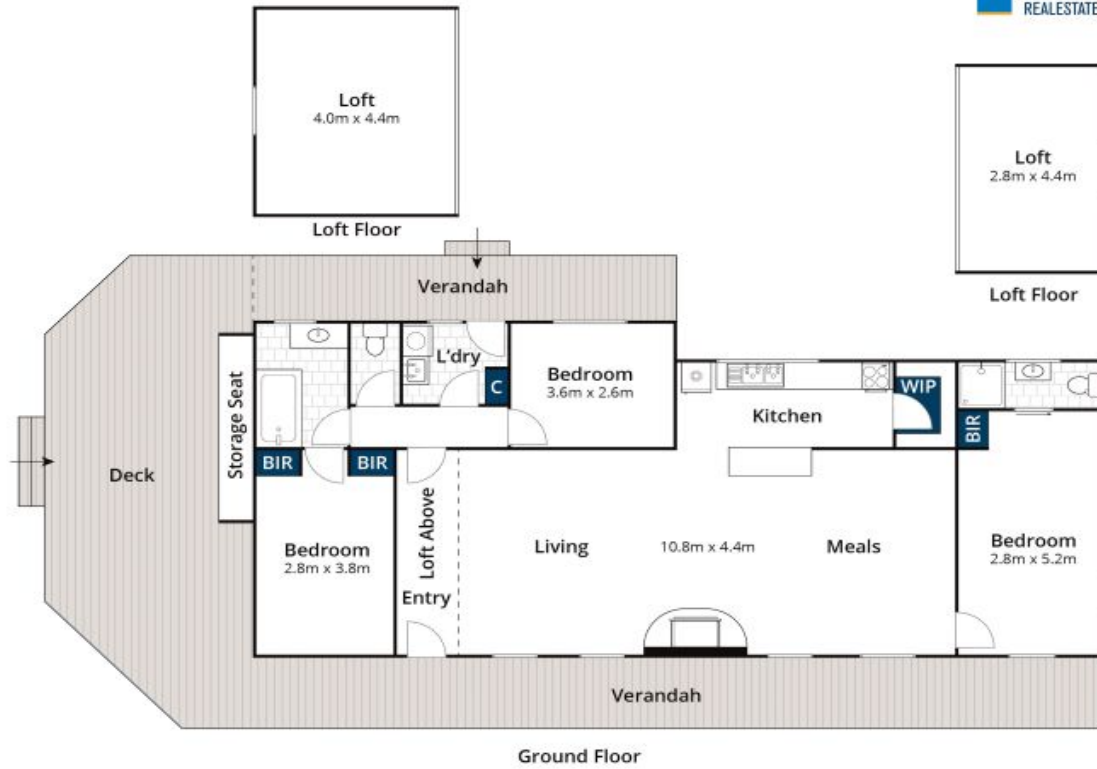

Whilst bwrn.com.au has made every attempt to ensure the accuracy of the floor plan contained here, measurements are approximate and no responsibility is taken for any error, omission, or mis-statement. This plan is for illustrative purposes only.

7 Bambra Road, Aireys Inlet