



15 Fernleigh Terrace Lorne, VIC



THE PERFECT LORNE BEACHSIDE ESCAPE

Positioned in the sought-after Swing Bridge precinct, this property offers effortless access to the beach and town amenities, all within a short stroll. This home is move-in ready, inviting you to embrace cozy winter nights by the open fire or host summer gatherings on the expansive north-facing deck.

Every detail of this residence has been meticulously planned to blend its beach house charm with modern conveniences. The kitchen's hydraulic servery window seamlessly connects to the deck, and the main bathroom boasts a lavish freestanding bath. Enjoy ocean and beach views from multiple decks, and let the kids play in the grassed rear yard.

Featuring 4 bedrooms, 2 bathrooms, and an open-plan kitchen/dining/living area upstairs, along with a self-contained bedroom, ensuite, and kitchenette downstairs, the layout offers versatility. It's perfect for multi-generational families or can be divided into two rental spaces for additional income.

Price: \$2,450,000

Tyrone Provan
0405 124 799

Karen Stribling
0439 650 838

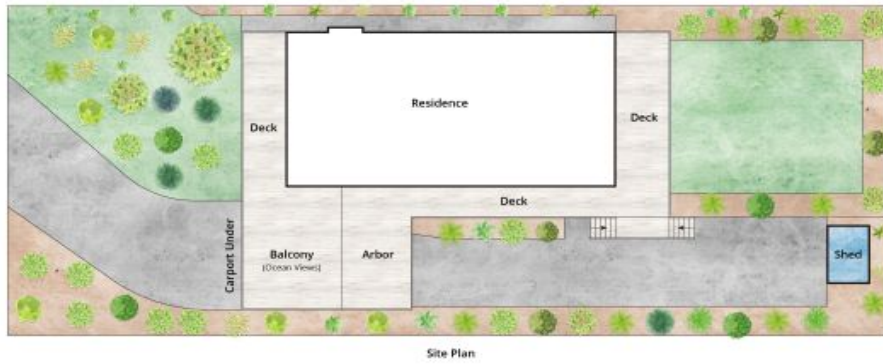

Whilst bwrn.com.au has made every attempt to ensure the accuracy of the floor plan contained here, measurements are approximate and no responsibility is taken for any error, omission, or mis-statement. This plan is for illustrative purposes only.

15 Fernleigh Terrace, Lorne