



11 Lialeeta Road Fairhaven, VIC



4



3



5

## VIEWS, ACCOMMODATION AND POSITION

Located on the sheltered side of Lialeeta Road with a gorgeous, sunny, easterly aspect, this late 1980s home has plenty of accommodation, ocean views and terrific beach access.

The house is all on one level and consists of a generous open plan living/kitchen/dining area with a wood heater and electric heating, all enjoying ocean, inlet and lighthouse views which cannot be compromised. Access to the patrolled Fairhaven Beach and Fairhaven SLSC is seconds away via Flax Lily Lane which is directly across the road.

Accommodation is vast and comprises four large bedrooms, all with BIRs (master with WIR) a separate bathroom, plus an ensuite off the main bedroom.

There are a choice of two outdoor deck areas with a deck across the front of the house enjoying the views, and a rear deck enjoying protection from the wind.

**James Worssam**

0418 585 815

**Liz Currie**

0437 213 229

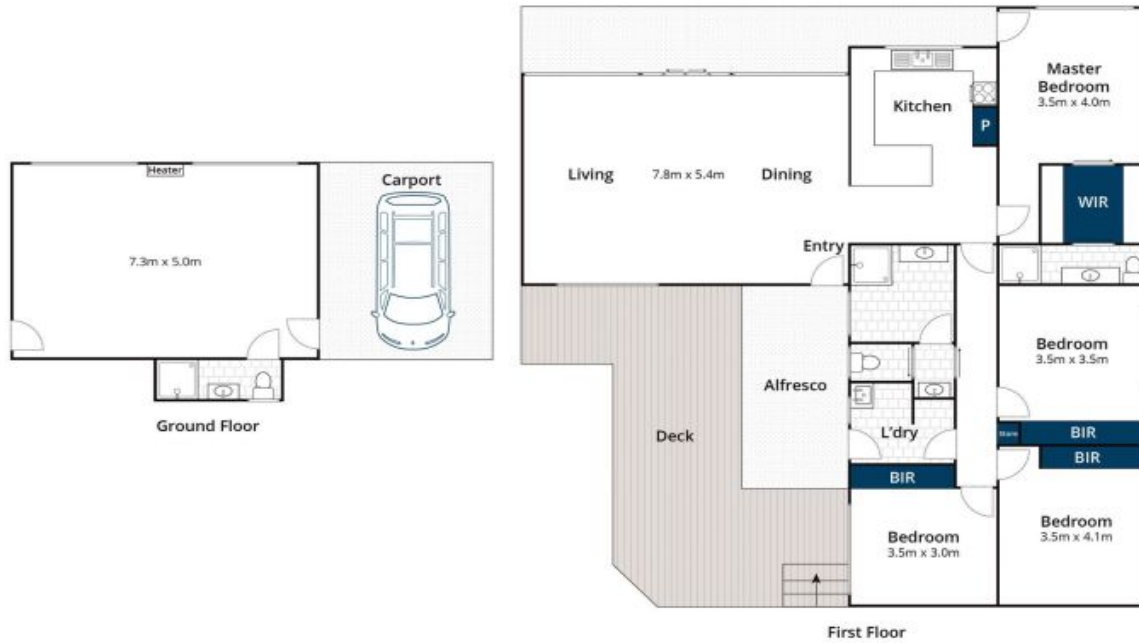

Whilst [bwr.com.au](http://bwr.com.au) has made every attempt to ensure the accuracy of the floor plan contained here, measurements are approximate and no responsibility is taken for any error, omission, or mis-statement. This plan is for illustrative purposes only.

## 11 Lialeeta Road, Fairhaven