



24 Deans Marsh Road Lorne, VIC



4



2



3

KING SIZE BLOCK WITH BIG TIME VIEWS AND ENDLESS PO...

Perfectly positioned on the tightly held, low side of Deans Marsh Road, this charismatic and much-loved family home offers immediate enjoyment and future promise. With four generous bedrooms, two bathrooms and multiple inviting living zones, there's plenty of space to relax, entertain or simply soak up the coastal ambience.

Set on a substantial allotment of 970 sqm (approx.), the home invites low-maintenance living today, with exciting potential to further enhance and make the most of this premium location in years to come.

Enjoy effortless access down to the iconic Great Ocean Road and sandy shoreline below via Doble Street or the public walkway a few doors down.

Price: \$2,400,000

Tyrone Provan

0405 124 799

Karen Stribling

0439 650 838



(Not In Position)



Ground Floor

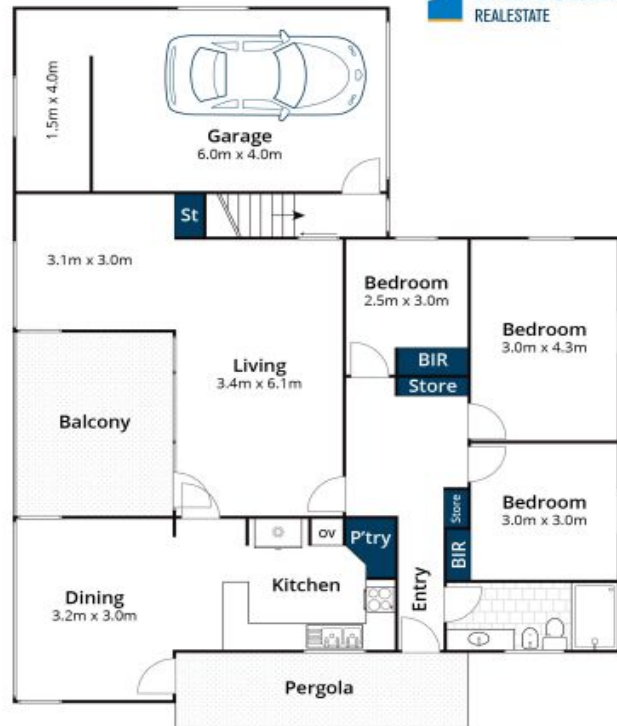

First Floor

Whilst bwr.com.au has made every attempt to ensure the accuracy of the floor plans contained here, measurements are approximate and no responsibility is taken for any error, omission, or mis-statement. This plan is for illustrative purposes only.

24 Deans Marsh Road, Lorne