



25 Bay Street Lorne, VIC



PRIME LOCATION, HIGHLY SOUGHT ORIENTATION

In the tightly held landscape of Lorne, some opportunities simply carry more weight than others. Offered for the first time in over 70 years, this charismatic and much-loved family home presents with expansive ocean and coastline views, a colossal 974sqm (approx.) allotment, an ultimate North-East orientation and a central location that is second to none.

The existing home is a testament to decades of coastal memories and the home is perfectly comfortable and ready for immediate enjoyment. Featuring three generous bedrooms and an expansive, sun-drenched open-plan living zone, it offers a functional base to relax and soak up the authentic Lorne ambience while you contemplate the future.

However, the true headline here is the land. A king-sized block of this magnitude, featuring such a perfect aspect, is a dream-home builder's greatest asset. Greet each day with a spectacular sunrise over the ocean and unwind as the sun dips behind the Otways-this is a position that demands a home of equal significance.

Price: \$1,725,000

Tyrone Provan
0405 124 799

Karen Stribling
0439 650 838

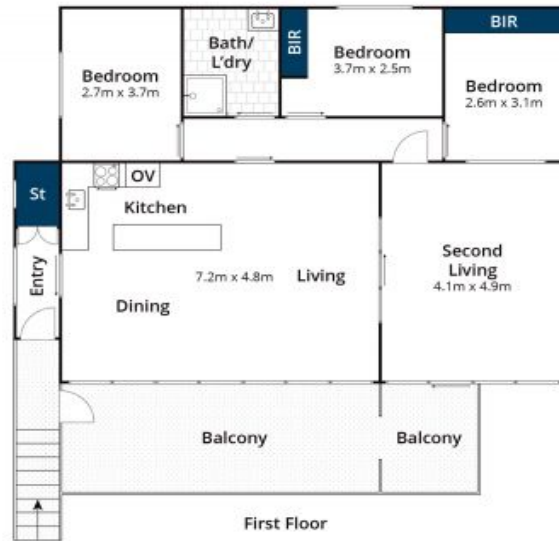
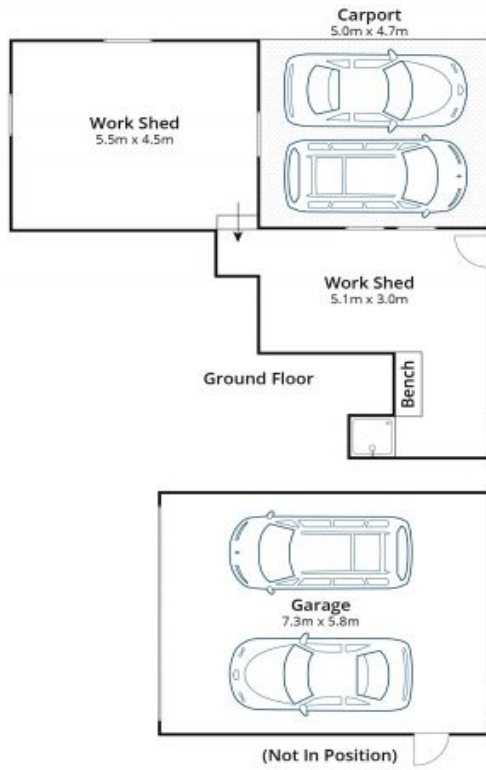

Whilst bwm.com.au has made every attempt to ensure the accuracy of the floor plan contained here, measurements are approximate and no responsibility is taken for any error, omission, or mis-statement. This plan is for illustrative purposes only.

25 Bay Street, Lorne