

4 Holmwood Avenue Anglesea, VIC

 2
  1
  2

## A-FRAME LIVING, A TIMELESS COASTAL CLASSIC!

A-frames aren't just homes, they're a feeling. Instantly recognisable, they've long been celebrated for their striking form, soaring ceilings and effortless connection to the outdoors. There's a simplicity to them that just works, light-filled, inviting and rich in character, where weekends feel longer and life slows to a more relaxed coastal rhythm.

Quietly tucked away in one of Anglesea's most tightly held pockets, this classic A-frame beach house offers charm, simplicity and exciting future potential.

Designed for easy coastal living, the heart of the home is an open plan living zone that flows seamlessly to a sunny front deck, the perfect setting for relaxed post-beach dinners with family and friends. A functional kitchen and bathroom, along with two loft-style bedrooms above, create a warm and welcoming retreat.

**Inspect:** Saturday, 9th May 2026 10:30 - 11:00

**Price:** \$1,090,000

**Paula Fowler**  
0407 031 178

**Jess Nowson**  
0493 896 000

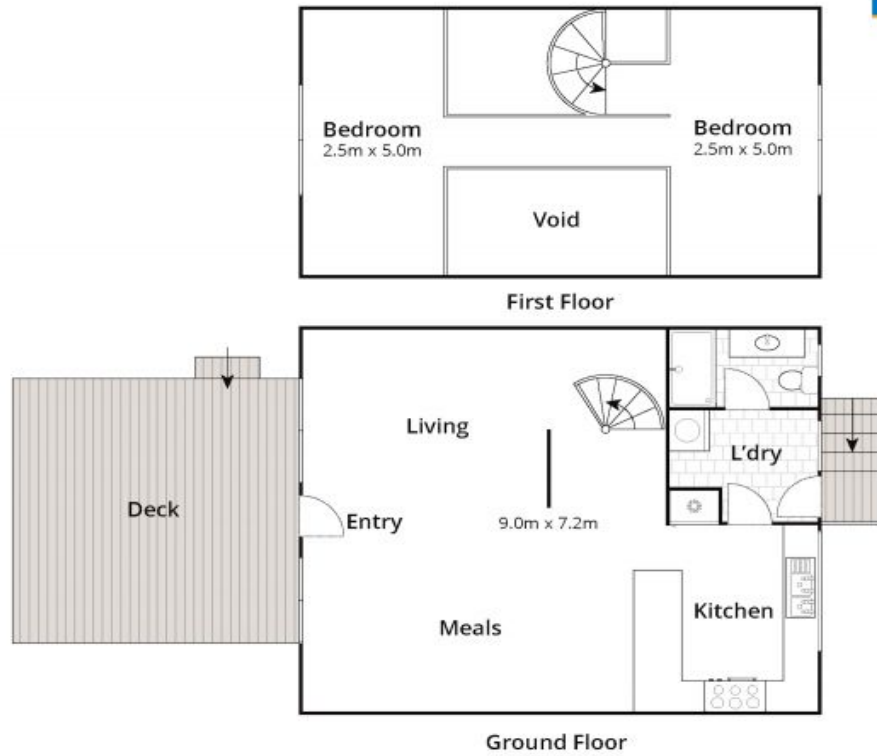

Approx House Area 112m<sup>2</sup>

Whilst [bwrn.com.au](http://bwrn.com.au) has made every attempt to ensure the accuracy of the floor plan contained here, measurements are approximate and no responsibility is taken for any error, omission, or mis-statement. This plan is for illustrative purposes only.

## 4 Holmwood Avenue, Anglesea